



Available SF: 1,625

Total Building SF: 6,500



**Address:** 8468 State St, South Gate, CA 90280  
**Cross Streets:** Independence Ave / State St

**Corner Retail / Commercial Unit**  
**Front & Side Entrance**  
**Open Area / Former Martial Arts Studio**  
**Just N of Firestone (42) Bl.**

**Lease Rate/Mo:** \$2,600  
**Lease Rate/SF:** \$1.60  
**Lease Type:** Gross  
**Terms:** 3 Years  
**Price/SF:** --  
**Sale Price:** --  
**Taxes:** \$4,647, 2016  
**Available SF:** 1,625  
**Minimum SF:** 1,625  
**Prop Lot Size:** POL  
**Yard:** No  
**Zoning:** CM

**Construction Type:** Frame and Stucco  
**Const Status/Year Blt:** EXIST / 1925  
**Sprinklered:** No  
**Ground Lvl Drs/Dim:** 0 / --  
**Dock High/Dim:** 0 / --  
**Clear Height:** 10  
**Heat/Cool:** None  
**Roof Type:** Lam Glu WB  
**A: 100 V: 110 Ø: 3 W: 3**  
**Parking Spaces: /Bldg Ratio:** --  
**Rail Service:** No  
**Specific Use:** Other

**Office SF / #:** 0 / --  
**Restrooms:** 1  
**Office Air:** No      **Office Heat:** No  
**Finished Ofc Mezz:** 0 SF  
**Include In Available:** No  
**Unfinished Mezz:** 0 SF  
**Include In Available:** No  
**Possession:** Now  
**To Show:** Call Agent  
**Region:** LA Central/Commerce/Vernon  
**Thomas Guide:** 705-B2  
**APN#:** 6211-005-010

**Listing Company:** Penta Pacific Properties - Santa Fe Springs (562) 699-1922

**Agents:** Douglas Wells (562) 908-6012x

**Property/Listing/Ste #:** 705844/1944105/3069168

**Listing Date:** 09/15/2017

**FTCF:** CB300N000S000/AOAA

**Notes:** Call broker for appt. to tour. (see reverse)

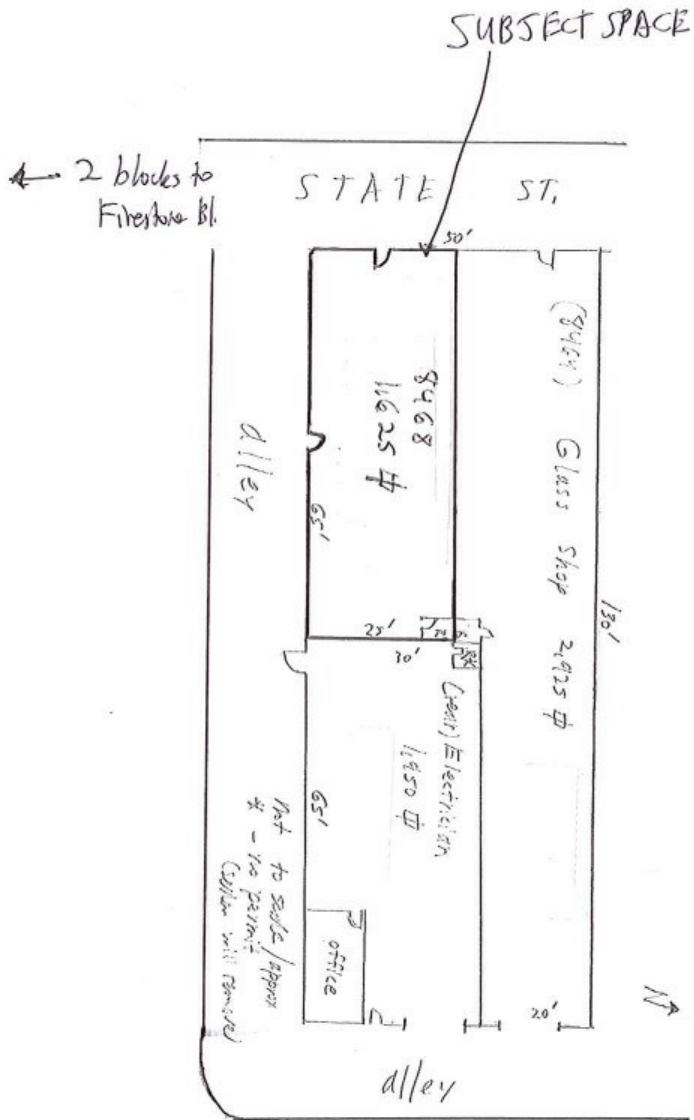

This information has been obtained from sources believed reliable. While we do not doubt its accuracy, we have not verified it and make no guarantee, warranty or representation about it. It is your responsibility to independently confirm its accuracy.