

Available SF 22,500 SF

Industrial For Sublease

Building Size 22,500 SF

**Address:** 6901 8th St, Buena Park, CA 90620**Cross Streets:** 8th St/S Knott Ave

Large Fenced Yard
 Great Mid Counties / North OC Location
 Dock High and Ground Level Loading
 600 Amps / 480 Volts
 Excellent Freeway Access to 5 and 91 Fwys

Lease Rate/Mo:	\$21,375	Sprinklered:	Yes	Office SF / #:	3,600 SF / 6
Lease Rate/SF:	\$0.95	Clear Height:	18'	Restrooms:	
Lease Type:	Gross	GL Doors/Dim:	2	Office HVAC:	None
Available SF:	22,500 SF	DH Doors/Dim:	1 / 12x15; 16x15	Finished Ofc Mezz:	0 SF
Minimum SF:	22,500 SF	A: 600 V: 277/480 O: 3 W:		Include In Available:	No
Prop Lot Size:	0.99 Ac / 43,124 SF	Construction Type:	Tiltwall	Unfinished Mezz:	0 SF
Term:	Acceptable to Owner	Const Status/Year Blt:	Existing / 1969	Include In Available:	No
Sale Price:	NFS	Whse HVAC:	No	Possession:	Now
Sale Price/SF:	NFS	Parking Spaces: 45 / Ratio: 2.0:1		Vacant:	Yes
Taxes:		Rail Service:	No	To Show:	Call broker
Yard:	Paved	Specific Use:	Warehouse/Office	Market/Submarket:	OC North
Zoning:	IND			APN#:	276-171-03

Listing Company: Penta Pacific Properties**Agents:** [Greg Jenkins 562-908-6020](mailto:greg@pentapacific.com)**Listing #:** 22059541**Listing Date:** 05/02/2019**FTCF:** CB250N000S000/A0AA**Notes:** Greg Jenkins (562) 618-9440 - Cell. greg@pentapacific.com. Sublease through Feb 2022. Longer Term Possible.

Greg Jenkins
 greg@pentapacific.com
 562-908-6020

AIRCRE
 Powered by: Catylist

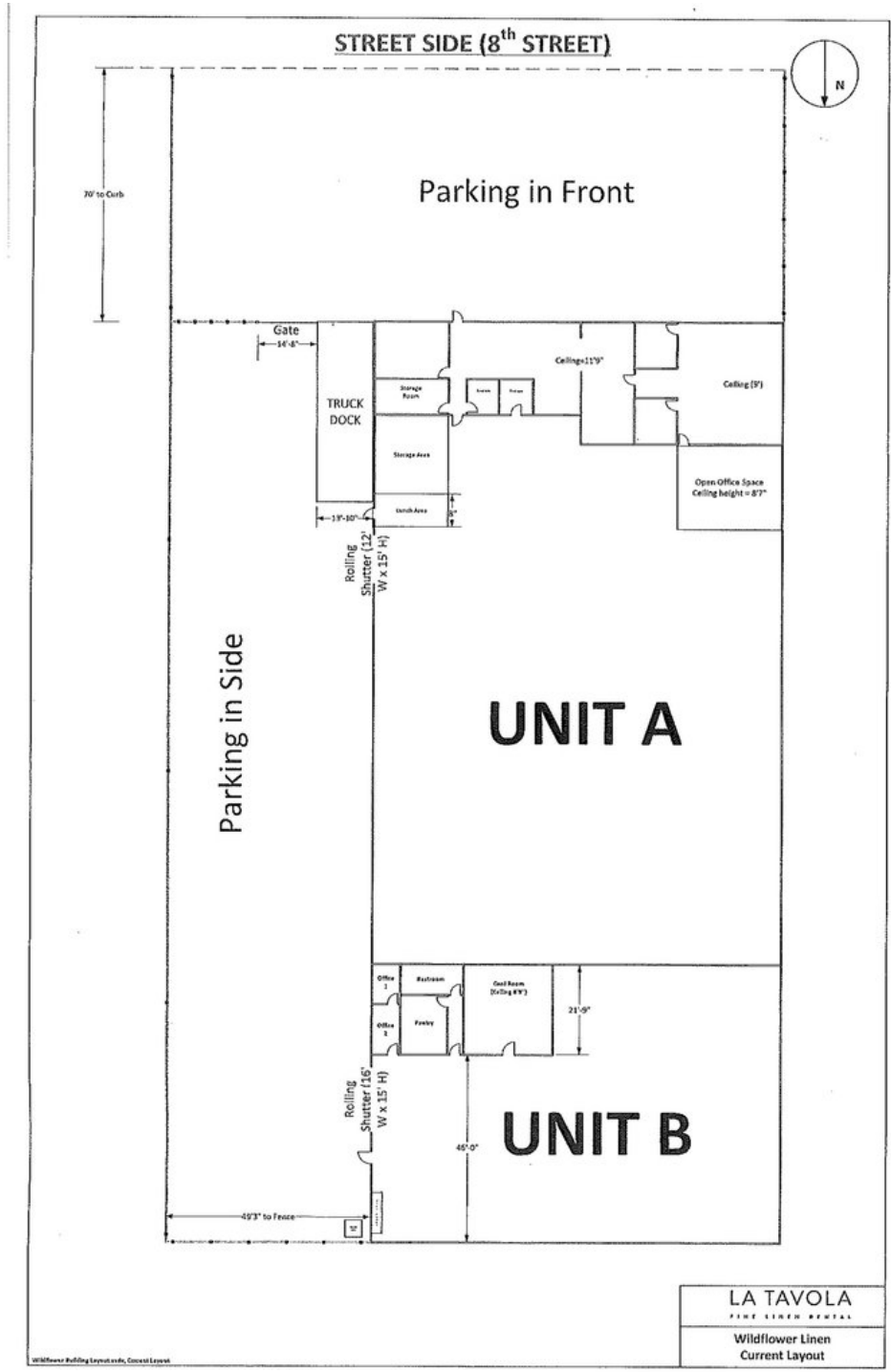

Greg Jenkins
greg@pentapacific.com
562-908-6020

